

Major 4.40

Electro-hydraulic 4-post lift, 4 t capacity



Application

- Check-in
- Repair and maintenance
- Wheel alignment
- Testing

Approvals / recommendations

- Volvo

Description:

Posts:

- Integrated eccentric brake system
- Emergency stop valve
- Obstruction system
- Pneumatic parking and safety system with height adjustable ratchets
- Pump unit with immersed motor and control unit on front left post
- Pushbutton control unit with alarm signal
- Hydraulic cylinder under left platform
- Lifting and lowering by means of cables
- Emergency lowering valve

Platforms:

- One moveable platforms as standard
- Platforms prepared for AUTOPSTENHOJ scissor jack

Standard colours:

- Platforms & posts: RAL 7016 – grey
- Ramps: RAL 3020 – red

Versions:

- Available with different voltages
- Drive-on ramps and stops for on-floor installation as well as for recessed installation available
- S = flush platforms
- WL = with filling pieces for flexible positioning of turn tables in front, and rear side ball bearing mounted slip plates, center cover plate between filling pieces and side slip plates
- G = galvanized platforms
- 44 = 4,400 mm platforms
- 48 = 4,800 mm platforms
- 51 = 5,100 mm platforms

Optional extras:

- Set of expansion bolts
- Extra control unit
- LED-lighting set
- Pneumatic lock cylinder kit for slip plates

Special colours available on request!



Scan the QR-Code for detailed product information.

Further Information on www.autopstenhoj.com

AUTOPSTENHOJ GmbH

Sandkampstraße 90
D-48432 Rheine
☎ +49 5971 8602-02
✉ info@autopstenhoj.com

AUTOPSTENHOJ GmbH

Barrit Langgade 188-190
DK-7150 Barrit
☎ +45 76 82 13 30
✉ info@autopstenhoj.com

Technical data	
Lifting capacity	4,000 kg
Lifting height	44 = 1,690 mm 48 = 1,850 mm 51 = 1,850 mm
Working height	S 44 = 1,840 mm S 48 = 2,000 mm WL 48 = 2,050 mm S 51 = 2,000 mm WL 51 = 2,050 mm
Lifting / lowering time	Standard: 24 / 26 sec.
Pump unit	Standard: 3 kW
Voltage	3x230 / 400V – 50 Hz - 25 / 16 A

Platforms	
Total length	44 = 5,490mm 48 = 5,890mm 51 = 6,190mm
Usable length of platform	44 = 4,400mm 48 = 4,800mm 51 = 5,100mm
Wheel base, min. - max.	51 S: max. 4.600 mm 51 WL: min. 2.100 mm, max. 4.100 mm
Platform width	550 mm
Distance between platforms	750 - 990 mm
Min. height	S = 160 mm WL = 210 mm
Width between posts	44 = 2,600 mm 48 = 2,600 / 3,000 mm 51 = 3,000 mm
Total width - outer edges base plates	26 = 3,032 mm 30 = 3,420 mm
Total height	2.445 mm

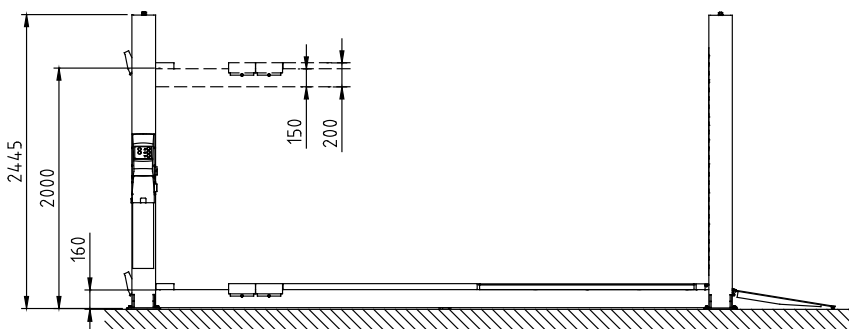
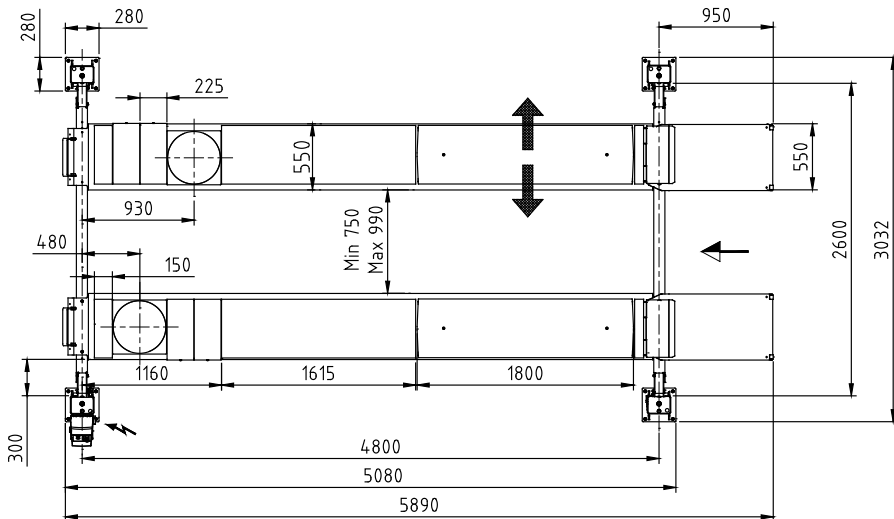

Long ramps available for low vehicles (optional)



Bended profile for high platform stability



Roller suspensions for scissor jack on the inside of the platform profile